



climbslide 6.8

moveart smartcity





Playsculpture climbslide 6.8

While adults will appreciate «climbslide 6.8» as an aesthetically designed play sculpture, children will see it as a small world full of adventures. Whether in the large or small version, «climbslide 6.8» guarantees not only fun but also encounters and movement.

Design:

All objects originate from a single form – the so-called double helix, the form of the DNA strands of all living things. They thus have an energising and harmonising effect on people and the environment.

Material:

All products are constructed using 100% ecological and sustainable Accoya wood, and have a minimum outdoor life span of 25 years. They are low-maintenance and resistant to vandalism.

Safety:

All objects are manufactured according to European safety standards for playground equipment SN EN 1176.

Tech. Specifications:

Length: 680 cm
 Width: 213 cm
 Height: 93 cm
 Weight: 850 kg
 Critical fall height: 93 cm
 Number of foundations: 5
 Construction time (approx.):
 4 pers. à 4 hrs.
 Crane required



THE HUMAN IGNITION PROFILE (HIP)

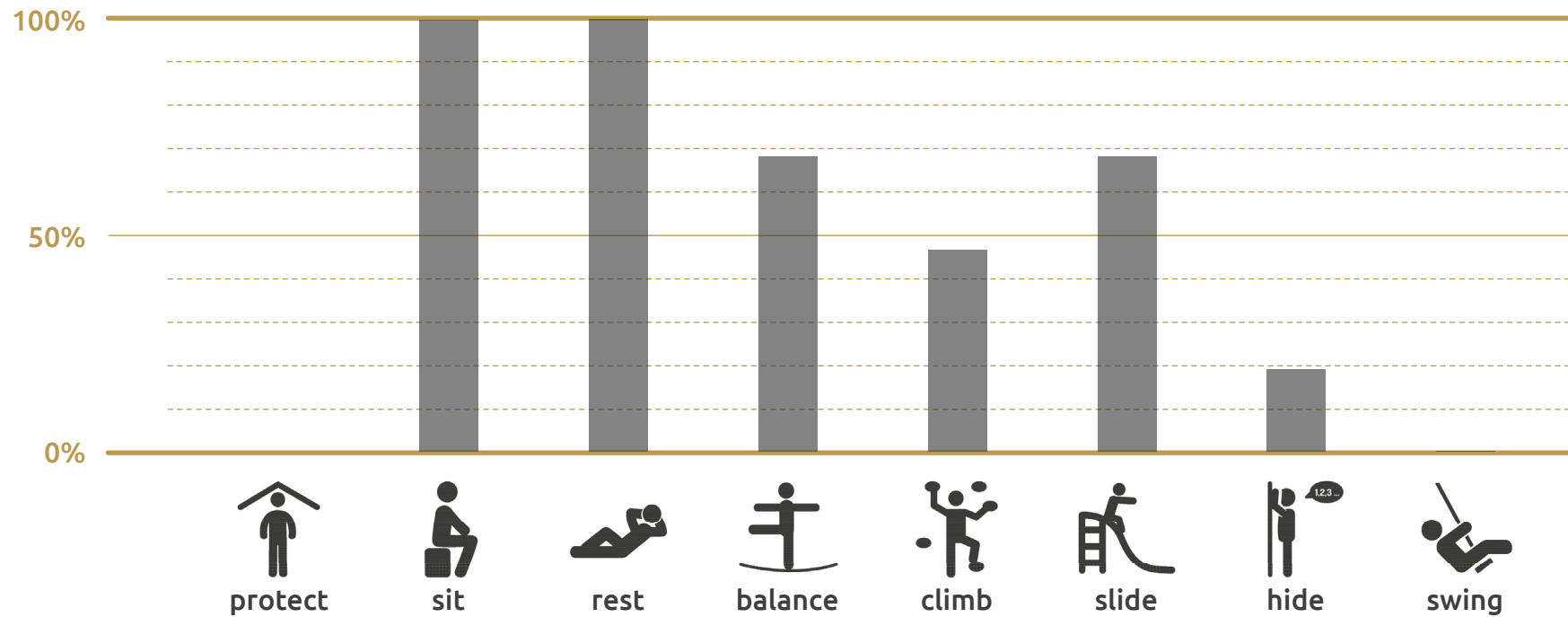

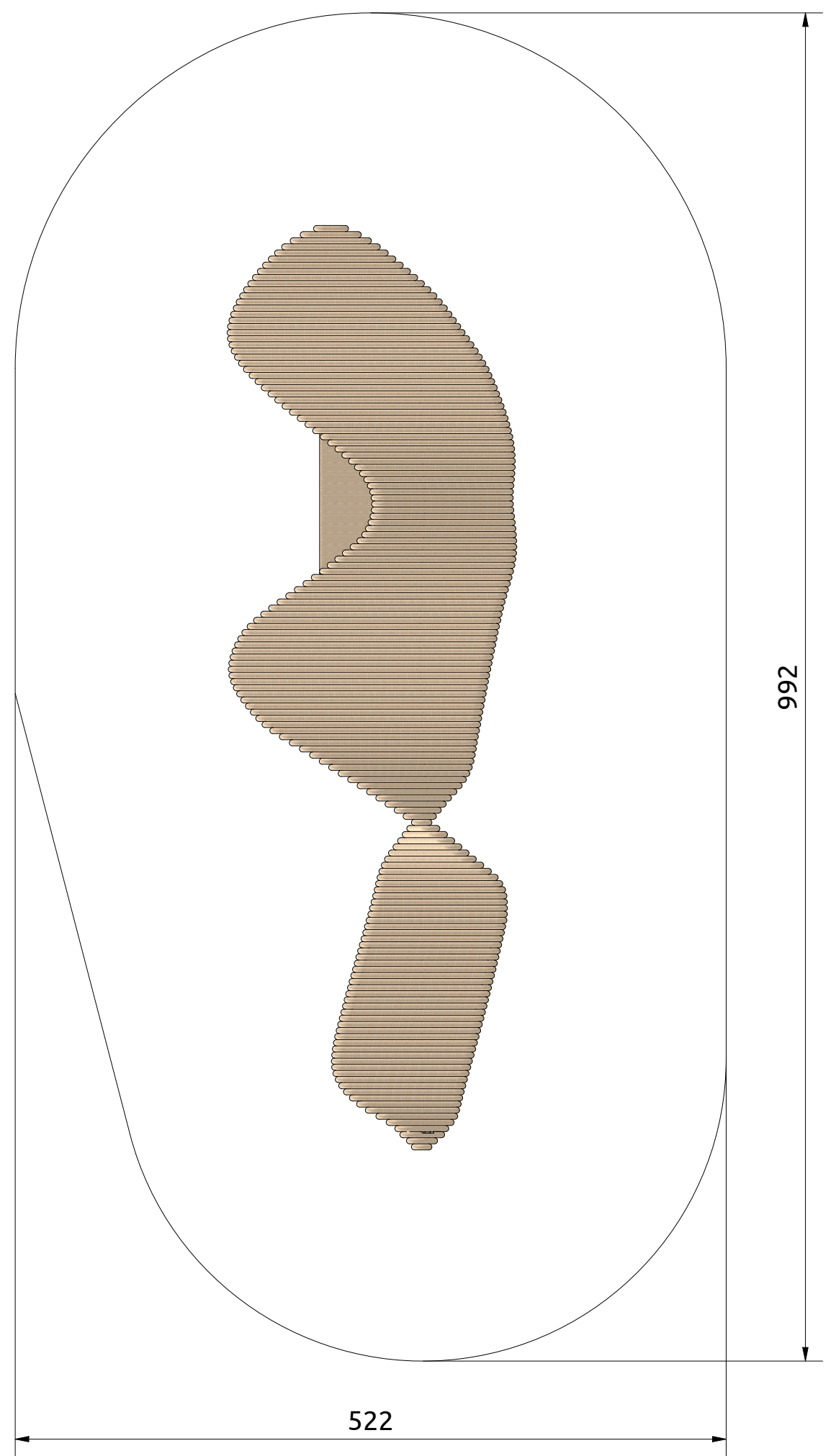
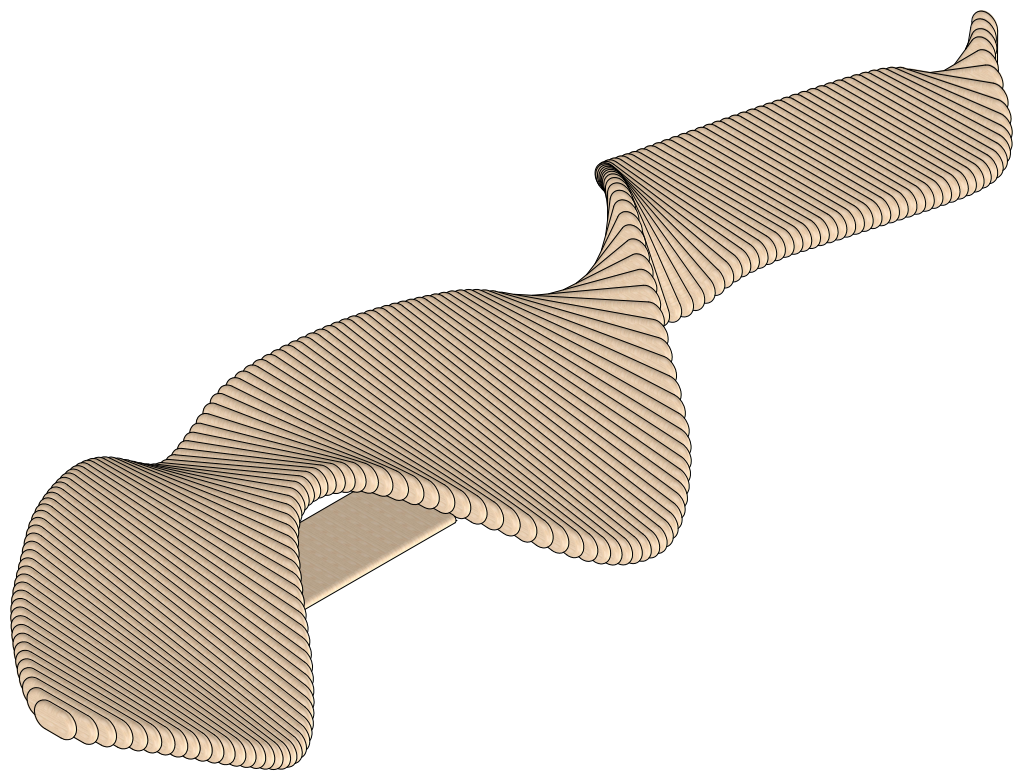
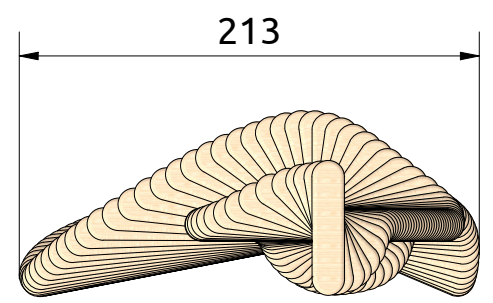
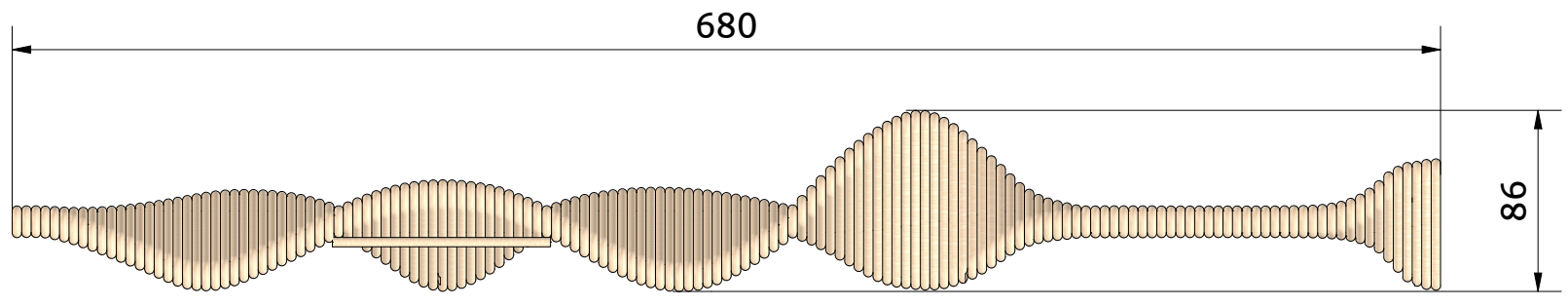

move art

moveART GmbH

Zürcherstrasse 8
CH-4143 Dornach

T +41 76 792 95 46

info@moveart.swiss
www.moveart.swiss