

# Instructions for wear checks of play equipment

The equipment must be checked for correct operation and safety, especially the points listed below:

Proof of maintenance

**Playground**.....

**Date of installation** .....

Checks depend on the type of equipment. Any equipment with moving parts must be checked at least twice a year, static equipment at least once a year.

Intervals for maintenance work and checks generally depend on

- the location
- the usage
- the frequency of use
- possible vandalism

For more details see also "General instructions for maintenance of playgrounds".

**Giant Revolving Disc**  
Order No. 7.25000

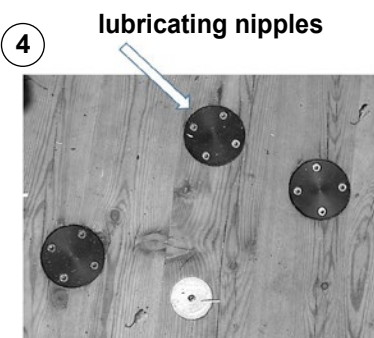
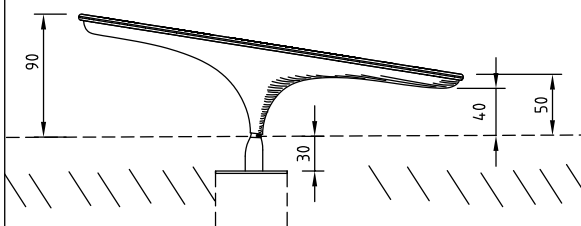
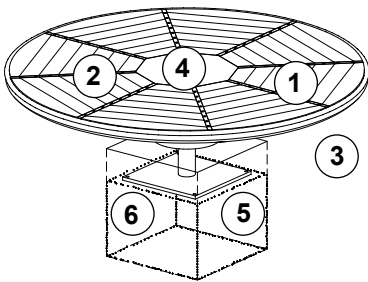

## Covering boards

1. Check for rot and, if necessary, smooth out splinters and round off sharp edges of cracks.
2. Check for wear and tear, replace if approx. half of the surfacing has been worn down.

## Functional parts

3. Check that the disc moves smoothly.
4. Check the smoothness of the rotating movement and, if there are bearing noises, grease the pivot bearing via the grease nipple (see diagram).

## Structural stability/ modelling of the ground

5. Check the stability of the foundation frame while stationary by rocking on one side and, if necessary, retighten the screws.
6. Check the fastening elements on the foundation frame for corrosion once a year.
7. Check the modelling of the ground, build up the ground profile according to the sketches, if necessary.

Please take into account the safety distances. By filling up with material you can create a ground profile in order to reduce the fall heights. Bark wood chips are very well suited for this.

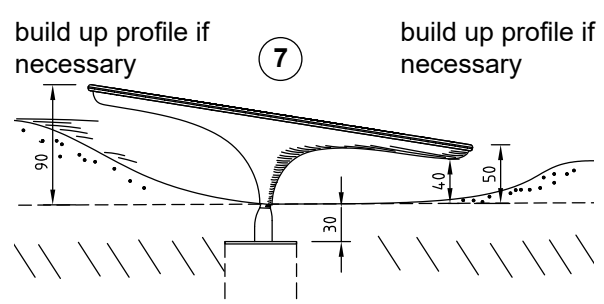

Repair not carried out, it is still possible to play on equipment

Repair not carried out, equipment is taken out of action

All work carried out, everything is in order

Maintenance carried out by: ..... Date .....

For spare parts refer to back of page.

Special notes, e.g. for repairs

COPYRIGHT © RICHTER SPIELGERÄTE GMBH En-EN 05.04.2023

**Spare Parts**  
**Giant Revolving Disc**  
**Order No. 7.25000**

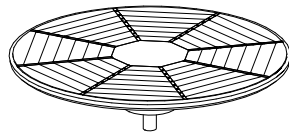

Please note that the safety standards of the equipment must not be affected. Therefore, when carrying out repairs it is helpful to **only use original parts**.

**Order No. Spare part**

**0.70100 foundation**

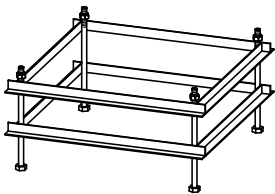

**0.20030 1 set of socket screws**

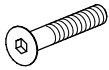

**99.00440 middle plate with screws**  
**8 x countersunk screws M10x60**

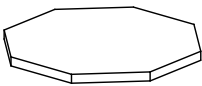

**0.20031 set of polyamide discs**  
**for middle plate**

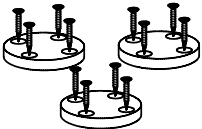

**0.98500 bearing set, complete**

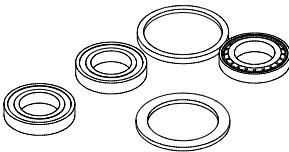

**99.00450 covering boards (= 8 segments)**  
**without screws and middle plate**

