

# Instructions for wear checks of play equipment

The equipment must be checked for correct operation and safety, especially the points listed below:

Proof of maintenance

Playground.....

Date of installation .....

Checks depend on the type of equipment. Any equipment with moving parts must be checked at least twice a year, static equipment at least once a year.

Intervals for maintenance work and checks generally depend on

- the location
- the usage
- the frequency of use
- possible vandalism

For more details see also "General instructions for maintenance of playgrounds".

## Suspension Bridge

Order No.	Length
3.66090	3 m
3.66100	4 m
3.66110	5 m

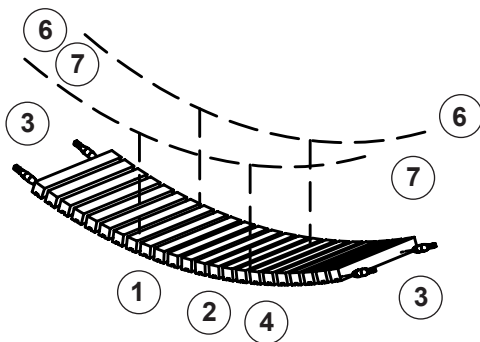

detailed diagram

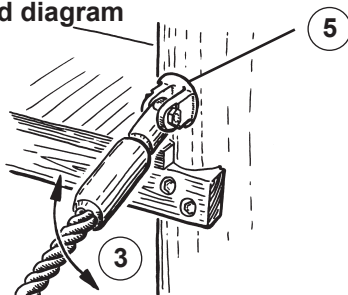

### Walkway

1. Check for rot and, if necessary, smooth out splinters and round off sharp edges and cracks.
2. Check that the running boards are connected properly.
3. Check joint of the carrying rope for wear and tear and make sure connections move smoothly.
4. Check carrying rope at the bridge for wear and tear.
5. Check connection to end frame or combination equipment, the tie joint must fit closely (see detailed diagram).

### Handrail chain

6. Check connection of fitting to end frame or combination equipment.
7. Check connection of chain to the fitting, the first chain link must be locked; check wear on contact surfaces between first and second chain link.







Special notes, e.g. for repairs

Repair not carried out, it is still possible to play on equipment

Repair not carried out, equipment is taken out of action

All work carried out, everything is in order

Maintenance carried out by:

For spare parts refer to back of page.

..... Date .....

**Suspension Bridge  
Order No. 3.66090/  
3.66100/3.66110**

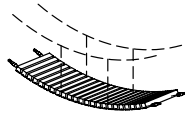

Please note that the safety standards of the equipment must not be affected. Therefore, when carrying out repairs it is helpful to **only use original parts.**

**Order No. Spare part**

**0.92310 joint for Hercules type rope**



**0.92320 handrail joint**

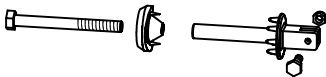

**0.92350 "Hercules" type carrying rope for suspension bridge 3 m**

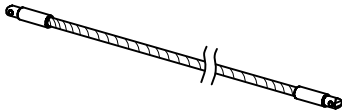

**0.85100 for suspension bridge 4 m**

**0.85000 for suspension bridge 5 m**

**0.92360 handrail chain for suspension bridge 3 m**

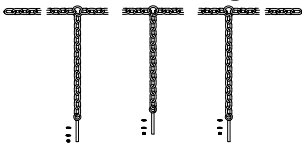

**0.88200 for suspension bridge 4 m**

**0.88210 for suspension bridge 5 m**

**0.92380 running board**

