

### Play value

During development of the embryo, the ear helps to regulate and balance the bodily functions between the mother and the unborn child. After birth the ear carries on its regulating function as a balancing organ. Due to lack of exercise and movement this ability can become retarded in many people. This can be experienced by standing on the Balancing Board and closing the eyes. You have to „hold on“ with your eyes. Maintaining balance on the Balancing Boards therefore is a game which promotes the activity of the individual organ at the same time as it revitalises the whole body. It promotes balance for the individual as well as in relationship with others and the environment. The connection between the functions of hearing and balancing becomes clear if participants try to balance in an extremely sound-proofed chamber. It can only be done with difficulty. The Balancing Boards can also be used for therapeutic purposes where the Balancing Discs provide the experience of balance and loss of balance.



Order No. 10.71200 Small Balancing Disc



Order No. 10.71100 / 10.71200 Small Balancing Discs

### Recommended for

- Kindergarten children
- School children
- Young people
- Supervised play areas, such as kindergartens, schools, after-school programmes or similar
- Public play areas without supervision, such as playgrounds, parks or similar

### Small Balancing Board Small Balancing Discs

Vandalism	not vulnerable
Supervision	not necessary
Explanation Board	not necessary
Installation	indoors and outdoors
Safety check (DIN EN 1176)	standard compliant
Installation in concrete	possible

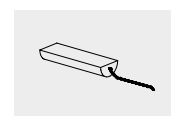

10.71000

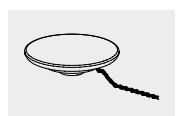

10.71100 / 10.71200

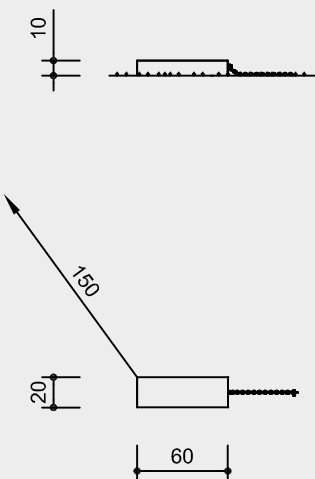
**Order No. 10.71000**  
**Small Balancing Board**

Safety distance →  
 Device dimensions —●—  
 Functional distance —|—

**Order No. 10.71100**  
**Small Balancing Disc**  
 for 1 Person

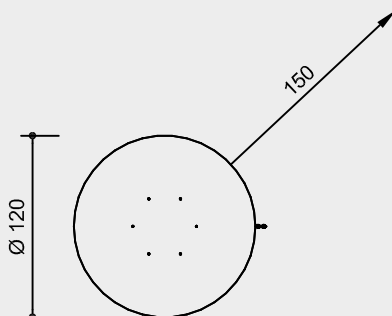
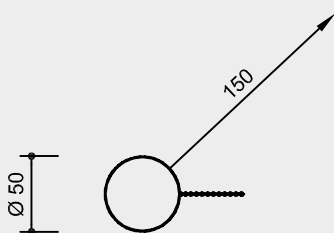
**Order No. 10.71200**  
**Small Balancing Disc**  
 for 2 - 3 Persons

Scale 1:50

**Technical information**

Balancing block made of solid ash wood  
 with anti-slip tread

**Core-free**

Sawn-timbers core-free, thus decreasing  
 occurrences of cracking and undesired  
 changes in shape

**Ground anchor**

All parts used for anchoring to the  
 ground are made of hot-dip galvanised  
 steel or stainless steel

**For more detailed explanation of the  
 quality characteristics see price list.**

Balancing disc made of waterproof  
 bonded plywood with anti-slip tread and  
 solid waterproof bonded ash wood

Secured against theft by ground faste-  
 ning with rotating joint made of stainless  
 steel, ground anchor and galvanised,  
 close-link chain twist-proof

**Dimensions**

(small deviations possible)

**Order No. 10.71000**  
**Small Balancing Board**

Length	0.60 m
Width	0.20 m
Height	0.10 m
Weight	10 kg

**Order No. 10.71100**  
**Small Balancing Disc**

Diameter	0.50 m
Height	0.14 m
Weight	15 kg

**Order No. 10.71200**  
**Small Balancing Disc**

Diameter	1.20 m
Height	0.18 m
Weight	25 kg

**Attention:**

**Exact measurements may vary;  
 for all installation dimensions refer  
 to current assembly instructions.**

Technical changes reserved.

**Components**
**Order No. 10.71000**

1 Small Balancing Board  
 including chain and fastening material

**Order No. 10.71100**

1 Small Balancing Disc for 1 person  
 including chain and fastening material

**Order No. 10.71200**

1 Small Balancing Disc for 2 - 3 persons  
 including chain and fastening material

**Trademark**

30 2005 500 000 Germany  
 40-0682207 South Korea

Explanation board on request

**Installation information**

Surfacing requirements  
 corresponding to a fall height of  $\leq 0.60$  m  
 (please refer to price list for more  
 detailed information)

Recommended space with safety distance

**Order No. 10.71000**

with chain  $\varnothing$  5.60 m  
 without chain  $\varnothing$  3.60 m

**Order No. 10.71100**

with chain  $\varnothing$  5.30 m  
 without chain  $\varnothing$  3.50 m

**Order No. 10.71200**

with chain  $\varnothing$  6.20 m  
 without chain  $\varnothing$  4.20 m

**Foundations**

1 item 30 x 30 x 20 cm  
 Excavation depth 50 cm

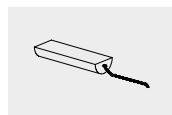
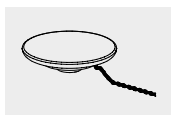
**10.71000**

**10.71100 / 10.71200**